



## General Purpose Knifegate Valves



# General Purpose Knifegate Valves



## VALVECO SERIES 710 KNIFE GATE VALVE FEATURES:

- Compact design for easy installation and maintenance
- Our Water Works range is Full 316SS construction (body & super structure)
- Available in metal & resilient seat
- Uni-directional design
- One-piece integral cast body, chest and lugs
- Integral cast in gate wedges minimize flow obstructions
- High flow rates with low pressure drops
- Gate guides to support gate
- Design and tested according to MSS SP-81
- Complies with AS6401 & MSS SP-81 face to face dimensions
- Every valve pressure tested
- Gate machined over full length for optimum sealing
- 50 to 1200mm sizes available, 50 to 600mm kept in stock
- 10 bar pressure rating
- Specifically formulated PTFE impregnated packing material for increased service life and lower friction
- Specialised packing for chemical resistant or abrasive applications available on request
- Available with a variety of actuators including handwheel, chain wheel, quick acting lever, geared, electric, air or hydraulic cylinder actuator

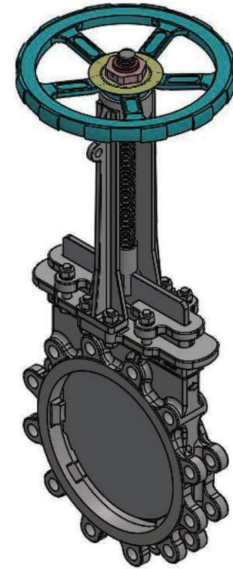

## OPTIONS INCLUDE:

Bonneted, Bi-directional, non-rising stem adapter, deflection cones, positioners, limit switches, solenoids, pneumatic failsafe & guards.

Valve CV & Torque Data			
Size	Metal Seat	Resilient Seat	Torque (Nm)
DN50	216	185	11.9
DN65	380	323	12.2
DN80	508	432	12.5
DN100	936	842	13.2
DN150	2196	1867	15.4
DN200	4020	3417	18.4
DN250	5625	4780	35.7
DN300	8460	7200	41.2
DN350	11250	9562	57.4
DN400	14850	12622	66.5
DN450	1926	17334	76.8
DN500	24300	20700	95.6
DN600	35430	32000	124.5

Data relating to larger sizes up to 1200mm is available upon request  
Torque values do not include Safety Factor

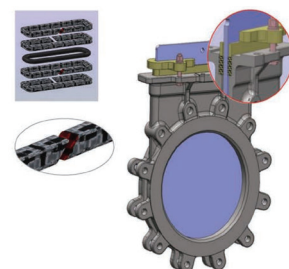
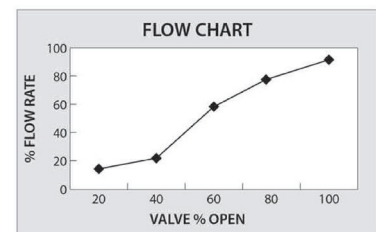

# General Purpose Knifegate Valves

## MANUAL ACTUATION STANDARD MATERIALS

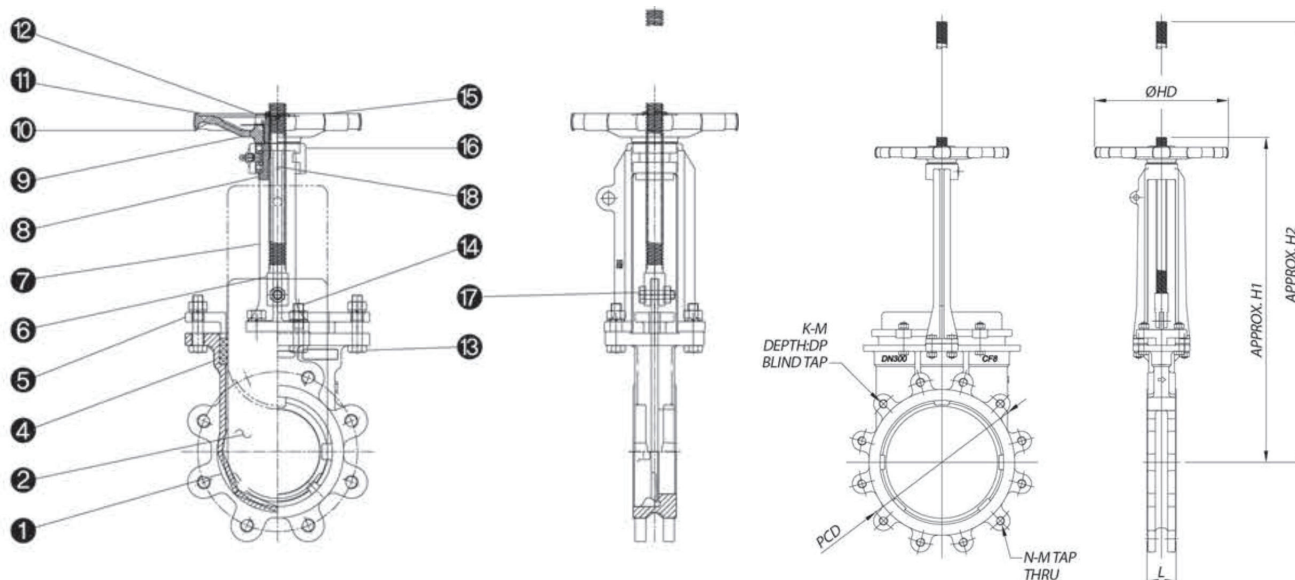

### DIMENSIONS:

No.	Part Name	Material Code (ASTM)
1	Body	Stainless Steel Gr. 316 and Gr. 304
2	Gate	Stainless Steel Gr. 316 and Gr. 304
3	Packing Gland	Stainless Steel Gr. 316 and Gr. 304
4	Super Structure	Stainless Steel Gr. 316 and Gr. 304
5	Sleeve	Bronze Casting (C83600)
6	Packing	PTFE Impregnated Braided Fibre

No.	Part Name	Material Code (ASTM)
7	Thrust Bearing	50 - 300mm: Thrust Plate (Bronze)
8	Hand Wheel	Cast Iron
9	Seat Ring	Stainless Steel Gr. 316 and Gr. 304
10	Fasteners	Stainless Steel Gr. 316 and Gr. 304
11	Clevis	Stainless Steel Gr. 316 and Gr. 304
12	Resilient Seat	Viton

Size (mm)	50	65	80	100	125	150	200	225	250	300	350	375	400	450	500	600
L (mm)	48	51	51	51	57	57	70	70	70	76	76	89	89	89	114	114
H (mm)	350	410	440	520	595	660	880	1025	1025	1190	1355	1530	1530	1690	1880	2200
PCD (mm)	114	127	146	178	210	235	292	324	356	406	470	495	521	584	641	756
W (mm)	200	200	200	225	250	250	280	350	350	400	400	450	450	450	600	600
N-H (T/D)	4-M16	4-M16	4-M16	4-M16	8-M16	8-M16	8-M16	8-M16	8-M20	12-M20	12-M24	12-M24	12-M24	12-M24	16-M24	16-M27
N-H (T/E)	4-M16	4-M16	4-M16	4-M16	8-M16	8-M20	8-M20	12-M20	12-M20	12-M24	12-M24	12-M24	12-M24	16-M24	16-M24	16-M30
N-H (ANSI)	4-5/8"	4-5/8"	4-5/8"	8-5/8"	8-3/4"	8-3/4"	8-3/4"		12-7/8"	12-7/8"	12-1"		16-1"	16-1 1/8"	20-1 1/8"	20-1 1/4"
Weight (kg)	9.5	12	13	16	19	22	34	53	53	65	90	145	145	180	227	282

### Note

The designs, materials, dimensions and specifications shown are subject to change without notice due to our continuing program of product development. Please request a certified drawing if dimensions are critical to our continuing program of product development. Please request a certified drawing if dimensions are critical.

# General Purpose Knifegate Valves

## PNEUMATIC ACTUATION STANDARD MATERIALS

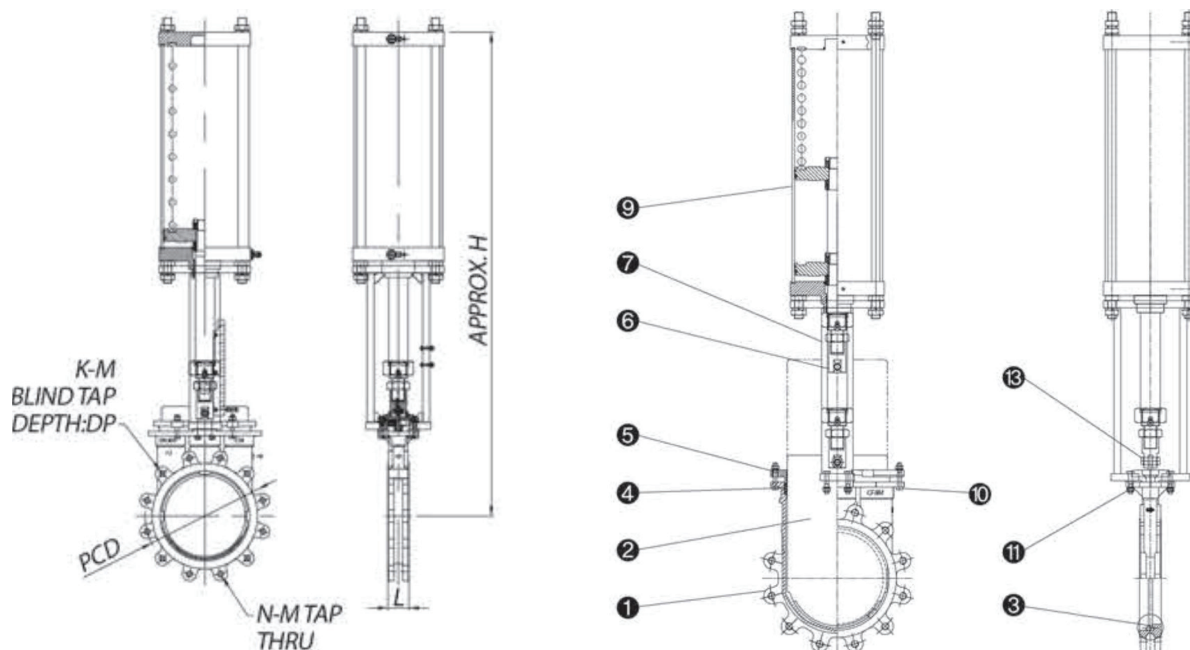

### DIMENSIONS:

No.	Part Name	Material Code (ASTM)
1	Body	Stainless Steel Gr. 316 and Gr. 304
2	Gate	Stainless Steel Gr. 316 and Gr. 304
3	Packing	PTFE Impregnated Braided Fibre
4	Packing Gland	Stainless Steel Gr. 316 and Gr. 304

No.	Part Name	Material Code (ASTM)
5	Super Structure	Stainless Steel Gr. 316 and Gr. 304
6	Clevis	Stainless Steel Gr. 316 and Gr. 304
7	Piston Rod	Stainless Steel Gr. 316 and Gr. 304
8	Cylinder	Aluminium or Fibreglass

Size (mm)	50	65	80	100	125	150	200	225	250	300	350	375	400	450	500	600
L (mm)	48	51	51	51	57	57	70	70	70	76	76	89	89	89	114	114
H (mm)	500	561	574	675	750	815	966	1181	1181	1340	1448	1648	1648	1834	2020	2120
PCD (mm)	114	127	146	178	210	235	292	324	356	406	470	521	521	584	641	756
N-H (T/D)	4-M16	4-M16	4-M16	4-M16	8-M16	8-M16	8-M16	8-M16	8-M20	12-M20	12-M24	12-M24	12-M24	12-M24	16-M24	16-M27
N-H (T/E)	4-M16	4-M16	4-M16	8-M16	8-M16	8-M20	8-M20	12-M20	12-M20	12-M24	12-M24	12-M24	12-M24	16-M24	16-M24	20-1 1/4"
N-H (ANSI)	4-5/8"	4-5/8"	4-5/8"	8-5/8"	8-3/4"	8-3/4"	8-3/4"		12-7/8	12-7/8"	12-1"		16-1"	16-1 1/8"	20-1 1/8"	494
Weight (kg)	11	13	15	21	25	31	58	103	103	137	158	172	172	202	256	494

### Note

The designs, materials, dimensions and specifications shown are subject to change without notice due to our continuing program of product development. Please request a certified drawing if dimensions are critical.