

# MPB SERIES TX600 METAL TUBE TRANSMITTING FLOWMETER



The TX600 Metal Tube Transmitting Flowmeter been designed to meet demanding high pressure and corrosive applications where a local display, transmitted out and signal functions are required.

The TX600 is manufactured in 3/4", 1", 2" and 3" flanged ANSI 150 RF and 3/4", 1" and 2" BSPFF (Rp) screwed versions.

The TX600, whilst having a range of standard flow rates, can be calibrated for almost any liquid or gas. The materials of construction will assist the designer in selecting a compatible flowmeter for the medium being processed.

The TX600 is ideal for high pressure flow indication. Applications can be found in the water, chemical and processing industries.

The TX600 incorporates a 4-20mA two wire transmitter.

This meets ATEX Ex ia IIC T4 specification.

This transmitter also includes two independently wired NAMUR set points.

For full specification and installation details, please read this In conjunction with MPBTB 120.

## FEATURES

- 4-20ma atex output
- Two fully adjustable namur alarms (hi/lo)
- Standard flanged length 250mm, screwed versions may exceed this
- Stainless steel construction
- Large clear analogue indicator displaying instantaneous flow rate
- Suitable for high pressure applications
- Suitable for corrosive applications
- Standard and customised flow scales
- Robust design
- Minimal maintenance
- For highly corrosive applications, please see the custom design MPB Series 5000 Transmitting Flowmeter (MPBTB 102)

### Process Connections:

3/4", 1" and 2" BSPFF ( Rp ) screwed, 3/4" 1", 2 and 3" flanged ANSI 150 RF, or to customer specification

### Display:

Highly visible analogue display

### Construction:

316 Stainless Steel

### Accuracy:

± 5% FSD predicted

### Max Working Pressure for Stainless Steel Gas and Liquid ( PED Group 2 ) :

3/4" - 50 barg or flange rating

1" - 50 barg or flange rating

2" - 65 barg or flange rating ( 18 barg for gas)

3" - 85 barg or flange rating ( 12 barg for gas )

### Max Ambient Temperature:

85°C

### Transmitter box Ingress protection:

IP6

### Electrical Specifications:

See Technical Bulletin MPBTB 120 for full electrical technical details. Two wire 4-20mA output with a 2 metre flying lead

Associated Namur outputs can be set Normally open / Normally closed. Atex Certified Rotary encoder - Ex ia IIC T4

Regarding flow ranges, this instrument is designed for specific high accuracy applications where corrosive gases and liquids are being metered.

For instance, the F5000 can cover flow ranges from 50 - 5000 L/min Air @ 1013 mbar abs 20oC.

Water flows from 2 - 150 L/min @ 20oC.

The above flow rates are approximations and MPB can bespoke design this product to suit customer requirement. Please consult our Sales Office for further information.

# MPB SERIES TX600 METAL TUBE TRANSMITTING FLOWMETER

## STANDARD RANGES 3/4"

WATER @ 20°C	
2 L/min	0.12 m <sup>3</sup> /hr
5 L/min	0.30 m <sup>3</sup> /hr
10L/min	0.60 m <sup>3</sup> /hr

## STANDARD RANGES 1"

AIR @ 1013 mbar abs 20°C		WATER @ 20°C	
1000 L/min	60 m <sup>3</sup> /hr	10 L/min	0.6 <sup>3</sup> /hr
1500 L/min	90 m <sup>3</sup> /hr	35 L/min	2 m <sup>3</sup> /hr
2500 L/min	150 m <sup>3</sup> /hr	50 L/min	3 m <sup>3</sup> /hr
3500 L/min	200 m <sup>3</sup> /hr	85 L/min	5 m <sup>3</sup> /hr
		100 L/min	6 m <sup>3</sup> /hr

## STANDARD RANGES 2"

AIR @ 1013 mbar abs 20°C		WATER @ 20°C	
1500 L/min	90 m <sup>3</sup> /hr	50 L/min	3 m <sup>3</sup> /hr
2000 L/min	100 m <sup>3</sup> /hr	100 L/min	6 m <sup>3</sup> /hr
5000 L/min	300 m <sup>3</sup> /hr	150 L/min	10 m <sup>3</sup> /hr
6000 L/min	350 m <sup>3</sup> /hr	200 L/min	12 m <sup>3</sup> /hr
7500 L/min	450 m <sup>3</sup> /hr	250 L/min	15 m <sup>3</sup> /hr
9000 L/min	550 m <sup>3</sup> /hr	300 L/min	18 m <sup>3</sup> /hr
		400 L/min	25 m <sup>3</sup> /hr

## STANDARD RANGES 3" (Flanged only)

AIR @ 1013 mbar abs 20°C		WATER @ 20°C	
7500 L/min	450 m <sup>3</sup> /hr	250 L/min	15 m <sup>3</sup> /hr
10000 L/min	600 m <sup>3</sup> /hr	350 L/min	20 m <sup>3</sup> /hr
12000 L/min	750 m <sup>3</sup> /hr	400 L/min	25 m <sup>3</sup> /hr
15000 L/min	900 m <sup>3</sup> /hr	500 L/min	30 m <sup>3</sup> /hr
19500 L/min	1200 m <sup>3</sup> /hr	650 L/min	40 m <sup>3</sup> /hr

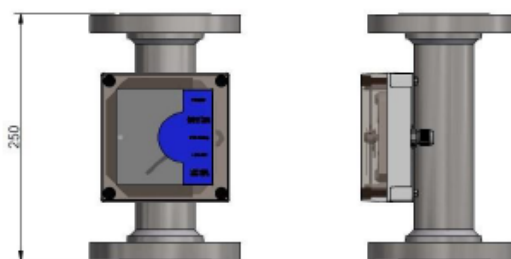
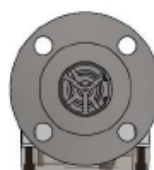

MODEL SHOW : 2" ANSI 150lb RF FLANGED

Customised flow ranges are available.  
Please consult MPB Industries to select the required flow range for the process fluid used.

